

# The Dorina



- 53.51 m<sup>2</sup>
- 2 bedrooms
- 1 baths



- Great for:**
- Family home
  - Summer cabin
  - Social Housing

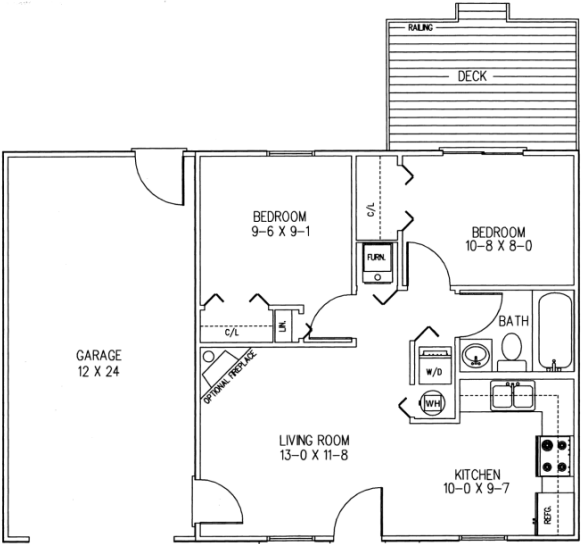

Elkview Value Plan

## Specifications

## Optional Enhancements

- ◆ One car garage
- ◆ Front porch
- ◆ Rear deck



- Living Area: 53.51 m<sup>2</sup>
- House width: 7.31 m
- House depth: 7.31 m
- Number of stories: 1
- Primary roof pitch: 4:12
- Roof framing: Truss
- Optional porch: 3.71 m<sup>2</sup>
- Optional deck: 7.43 m<sup>2</sup>
- Optional Garage: 26.75 m<sup>2</sup>
- Main ceiling height: 2.44 m

